



Warneford Court | 10, Mannoek Close | Colindale | NW9 5WD

Offers Over £250,000



STRETTONS

Key features

- One Bedroom First Floor Purpose Built Apartment
- Modern and Contemporary Design
- Chain Free
- Secured Gated Allocated Parking Space
- Video Entry System for Added Security
- Spacious Communal Gardens
- Open Plan Lounge/Kitchen/Diner
- Close Proximity To Shopping & Leisure Facilities

Description



Directions





Approximate Gross Internal Area
52.94 sq m / 569.84 sq ft

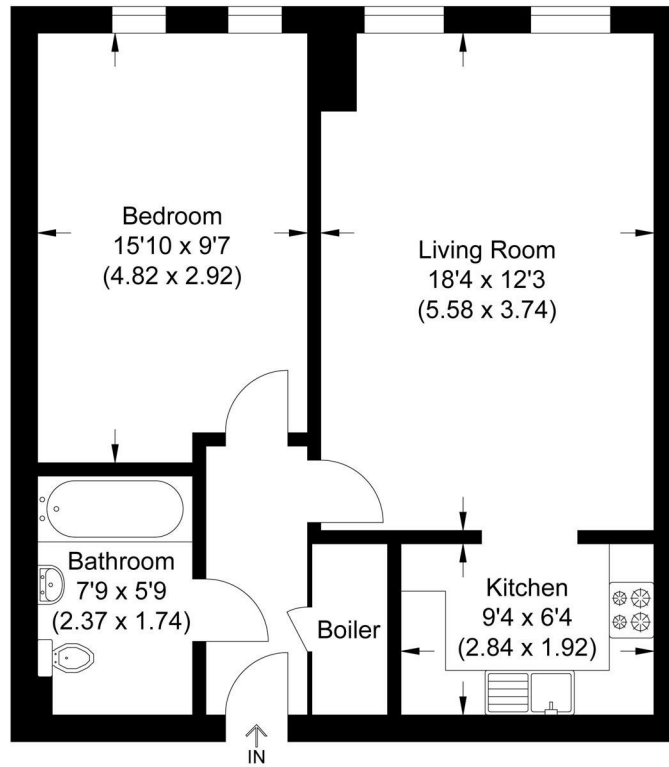

Illustration for identification purposes only, measurements are approximate, not to scale.

Energy Efficiency Rating		
	Current	Potential
<i>Very energy efficient - lower running costs</i>		
(92 plus) A		
(81-91) B		
(69-80) C	77	77
(55-68) D		
(39-54) E		
(21-38) F		
(1-20) G		
<i>Not energy efficient - higher running costs</i>		
England & Wales	EU Directive 2002/91/EC	

Council Tax Band C EPC Rating C



69 Paul Street
London
EC2A 4NG
020 7637 4000

bryn.nettle@strettons.co.uk